

# CHALLENGER ADVANTAGE

50 kg & 100 kg Service Lifts

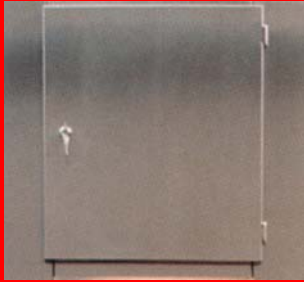

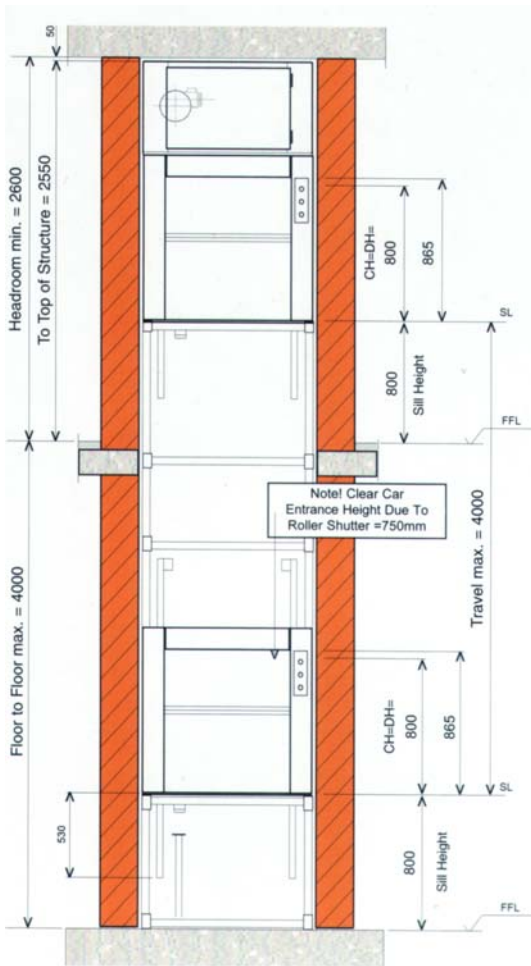

ELEVATION SECTION "X-X"

## STANDARD SPECIFICATION

### CAPACITY

50kg or 100kg

### SPEED

0.45 m/s

### DRIVE SYSTEM

Traction Drive

### ELECTRICITY SUPPLY

400 Volts, 3 Phase or 240 Volts, Single Phase

### TRAVEL

Up to 4m (adjustable on site)

### ARRANGEMENT

2 Floor / 2 Entrance

Single or Through Entry (adjustable on site)

### STRUCTURE

Galvanised steel structure

Polyurethane buffers

### CAR

Finished in Stainless Steel

For Sizes Refer to Chart Below

Removable Mid-Shelf

### LANDING DOORS

2 Hour Fire-rated

Finished in Stainless Steel

### CONTROL SYSTEM

Microprocessor Controller (with removable cover)

### ELECTRICAL

Pit Stop Switch

Additional Auxiliary Main Contactor

Phase Failure Reversal Relay

Position Indicator

Lift in Use indicator

Lift Arrival Buzzer

Door Open Alarm Buzzer

Anti Quick-reversal

Overtravel Timer

Hand Lamp

Light and Socket within Machine Room

Wiring in Loom Form

### GENERAL

Full Set of Warning Notices

User Manual

Comprehensive Installer Instructions

Layout Drawings & Wiring Diagrams

Compliance with BS5655 Part 3

Compliance with European Machinery Regulations

Carries the European 'CE' Mark

## OPTIONAL FEATURES

Lockable Machine Room Access Door

Finished in Stainless Steel

2 Hour Fire-rated

Brushed aluminium roller shutter fitted with

electrical contact (two shutters must be

fitted on all through entry cars to comply

with regulations)

AVAILABLE IN THREE ARRANGEMENTS AS SHOWN ON PLAN BELOW  
(AVAILABLE WITH OR WITHOUT MACHINE ROOM DOOR)

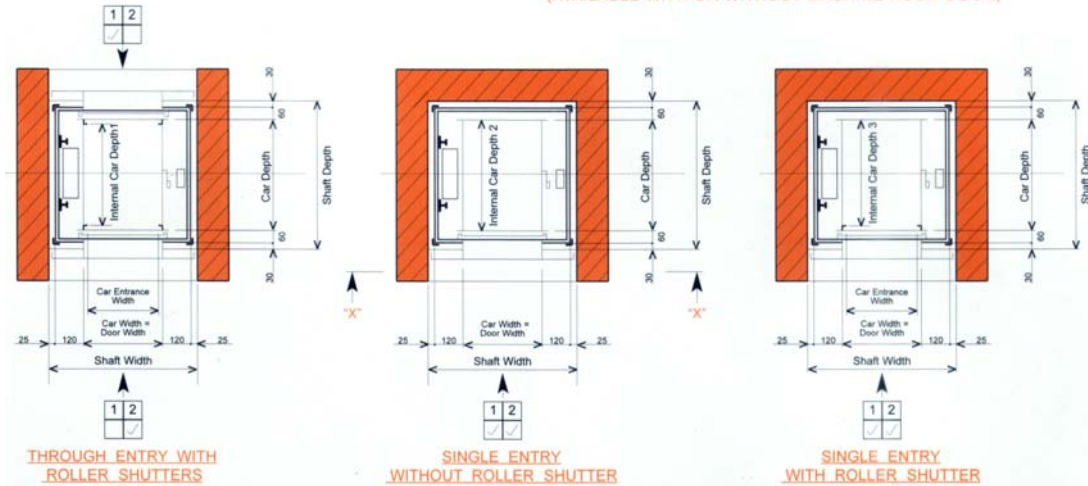

Capacity	Model	Speed	Car Width = Door Width	Car Depth	Car Entrance Width	Shaft Width	Shaft Depth	Internal Car Depth 1	Internal Car Depth 2	Internal Car Depth 3
50kg	50.45/4	0.45 m/s	460	570	420	750	750	500	570	535
100kg	100.45/4	0.45 m/s	710	820	670	1000	1000	750	820	785